

# HOW TO SECURE THE SOLAR LIGHT HEAD LUMINAIRE WITH TEF-GEL TO THE POLE



## STEP 1.

Apply Tef-Gel to 4 x countersunk holes at top edge of pole thinly spread as shown here.



## STEP 2.

Apply Tef-Gel to 4 x M6 Security bolts as shown here



## STEP 3 - ATTACH SOLAR LIGHT HEAD

If you are using a SBL2 **ASYMMETRICAL** light head, there will be a **RED ●** dot near the threaded brass insert which needs to be facing across the pathway.

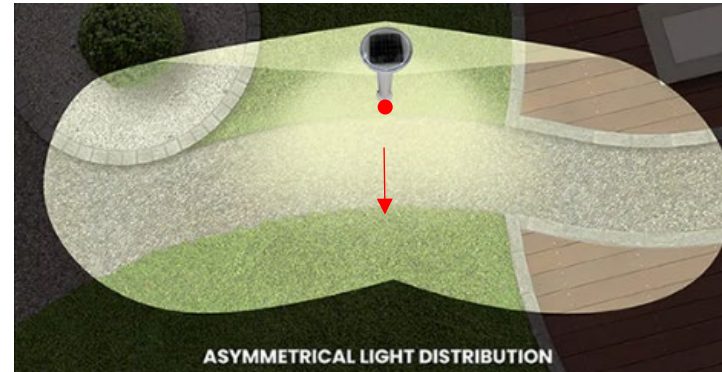

**TURN PAGE OVER FOR INSTRUCTIONS HOW TO SECURE THE SOLAR LIGHT HEAD LUMINAIRE TO THE POLE**



**STEP 4 - Remove the black shrink wrap from the light head to activate the system. Your Solar Light Bollard is now installed and operational.**

# HOW TO SECURE THE SOLAR LIGHT HEAD LUMINAIRE TO THE POLE

**STEP 1** - Install the Solar Light Head into the pole/mount pole section until the Solar Light Head spun collar is sitting flush with the top edge of the pole

**STEP 2** - Turn the Solar Light Head until you can see the internal brass threads in the moulding have lined up horizontally with the counter bored holes in the pole

- You will notice the internal brass thread is sitting slight above the top of the counter bored hole

**STEP 3** - Apply downward pressure to the top dome section of the Solar Light Head, this will line up the thread vertically now.

This now creates compression on the Spun Collar & O-Ring, creating a watertight seal

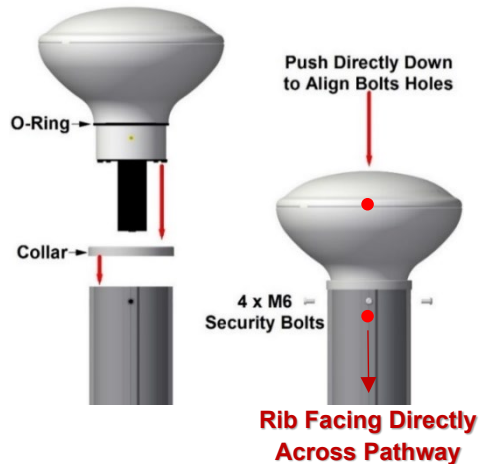

**USING 2 PIN SECURITY DRIVER BIT  
- MUST SIT FLAT -**

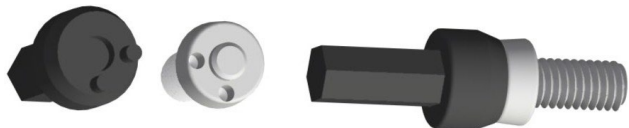

**SECURITY FASTENERS MUST BE TENSIONED  
IN THE SAME ORDER 1 2 3 4**

**STEP A - MUST BE COMPLETED BY HAND  
TENSION ONLY**

**STEP A:** Insert the M6 Security Fastener with the Security Driver Tool through the pole into the internal thread and tension until the Security Fastener head is above the external pole outer edge.

- Do this for each Security Fastener in order 1 to 4 as shown

**NOW USING A VARIABLE SPEED TORQUE  
GUN FOR STEP B + STEP C**

- SPEED** - Low Speed Only
- TORQUE** - Set to **“13 MAXIMUM”**



**STEP B:**

Continue tensioning the Security Fastener in order 1 to 4 until the fastener head section **has just recessed into the counter bored hole.**

This will create pressure down onto the O-Ring Seal

**STEP C:**

Continue tensioning the Security Fastener in order 1 to 4 until the variable speed torque driver **CLUTCH RELEASES.**

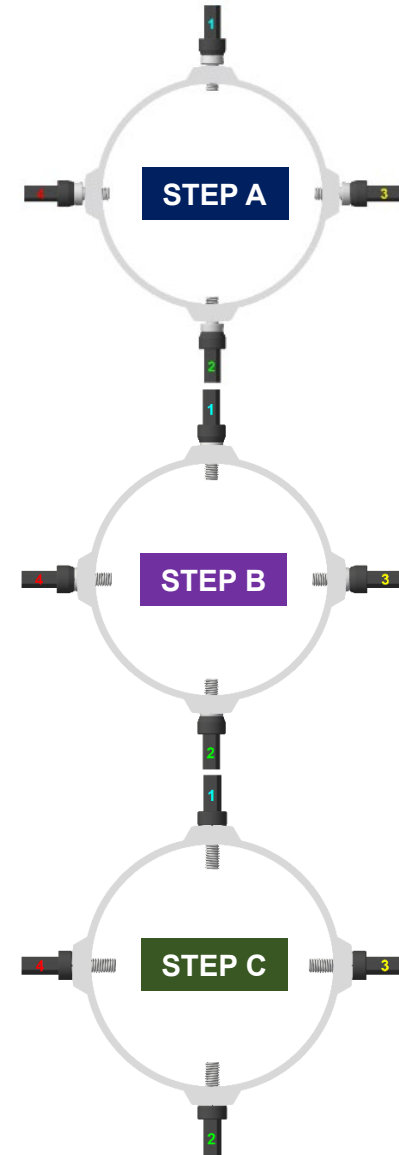

**STEP D: ENSURE THIS IS COMPLETED**

Then finally check tension by **HAND** to ensure the Security Fasteners are **TIGHT AND FIT**